

INDUCTION ELECTRIC TWO-SPEED SQUIRREL-CAGE ROTOR MOTORS TYPE 2AOD

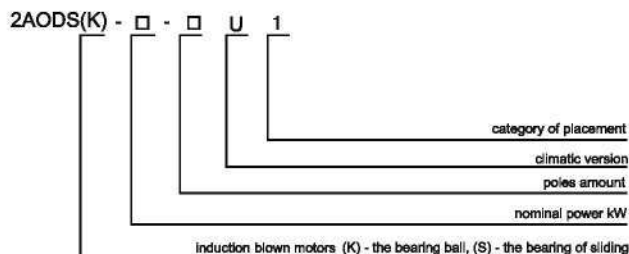

Conventional signs structure for motors series 2AOD



Induction electric two-speed squirrel-cage rotor motors type 2AOD are designed for driving mechanisms in a heavy starting duty (pumps, fans, smoke exhausters and so on).

Motors are designed for operation at a voltage of 6000V from the 50 Hz AC mains.

Climatic versions - U1.

The rated duty - continuous S1.

Type of construction - IM1101.

Cooling method - ICA01A61.

Degree of motor protection - IP44, terminal boxes IP55.

Direct-on-line starting of the motor is ensured at the rated mains voltage as well as at the drop of mains voltage during starting up to 0.8 U_{nom} . Motors allow two successive startings when cold or one starting when heated. Subsequent startings should be made with at least three hours intervals.

Motors are equipped with rolling-contact or bearing of sliding. Motors are coupled with the driven mechanism with a help of flexible coupling. The stator winding insulation is of thermosetting type "Monolit-2". Type of heat resistance is not lower than "B". Stator windings are star-connected. Leads of each stator winding are placed in separate terminal box. Motors have clockwise rotation. Motors with counterclockwise rotation can be made according to customer's requirements.

Electric motors type 2AOD substitutes series DAZ02 of 16,17,18 dimensions, made by JSC "ELECTROMASH".

Specifications for electric motors series 2AOD equipped with sliding bearings.

Type	Power, kW	Synchronous speed of rotation, rpm	Efficiency, %	cosφ, o.e.	Stator current, A	$\frac{M_{max}}{M_{nom}}$	$\frac{M_s}{M_{nom}}$	$\frac{I_{kl}}{I_{nom}}$	Mass moment of inertia, kgm ²
2AODS-1600/800-6/8U1	1600/800	1000/750	94.6/93.7	0.9/0.85	181/97	2.1/2.2	1.1/1.2	6.0/6.5	1277
2AODS-1250/630-6/8U1	1250/630	1000/750	94.3/93.5	0.9/0.85	142/76	2.2/2.2	1.2/1.2	6.5/6.2	1134
2AODS-1000/500-6/8U1	1000/500	1000/750	93.9/93.0	0.88/0.84	116/62	2.4/2.3	1.2/1.2	6.5/6.2	847
2AODS-800/400-6/8U1	800/400	1000/750	93.4/92.5	0.89/0.83	93/50	2.2/2.3	1.1/1.3	6.2/6.5	775
2AODS-630/315-6/8U1	630/315	1000/750	92.8/91.8	0.88/0.82	74/70	2.3/2.3	1.1/1.2	6.5/6.0	632
2AODS-1250/630-8/10U1	1250/630	750/600	94.5/93.4	0.86/0.76	148/85	2.1/2.4	1.2/1.3	6.2/6.5	1421
2AODS-1000/500-8/10U1	1000/500	750/600	94.0/93.1	0.85/0.76	120/68	2.1/2.2	1.2/1.2	6.2/6.0	1134
2AODS-800/400-8/10U1	800/400	750/600	93.7/92.7	0.85/0.75	97/55	2.1/2.4	1.2/1.4	5.8/6.0	990
2AODS-630/315-8/10U1	630/315	750/600	93.4/92.4	0.83/0.75	78/44	2.2/2.2	1.2/1.2	6.3/5.8	818
2AODS-500/250-8/10U1	500/250	750/600	92.9/91.7	0.82/0.72	63/36	2.2/2.3	1.2/1.3	6.2/6.2	675
2AODS-800/400-10/12U1	800/400	600/500	94.0/93.1	0.8/0.71	102/58	2.1/2.2	1.1/1.2	5.6/5.6	1421
2AODS-630/315-10/12U1	630/315	600/500	93.7/92.8	0.78/0.7	83/47	2.1/2.2	1.3/1.2	5.9/5.8	1206
2AODS-500/250-10/12U1	500/250	600/500	93.5/92.8	0.78/0.69	66/38	2.1/2.2	1.2/1.3	5.8/5.8	1062
2AODS-400/200-10/12U1	400/200	600/500	93.1/31.2	0.79/0.65	52/32	2.1/2.3	1.1/1.3	5.6/5.8	847

INDUCTION ELECTRIC TWO-SPEED SQUIRREL-CAGE ROTOR MOTORS TYPE 2A0D

Overall, mounting, connecting dimensions and mass of the motors type 2A0D equipped with sliding bearings.

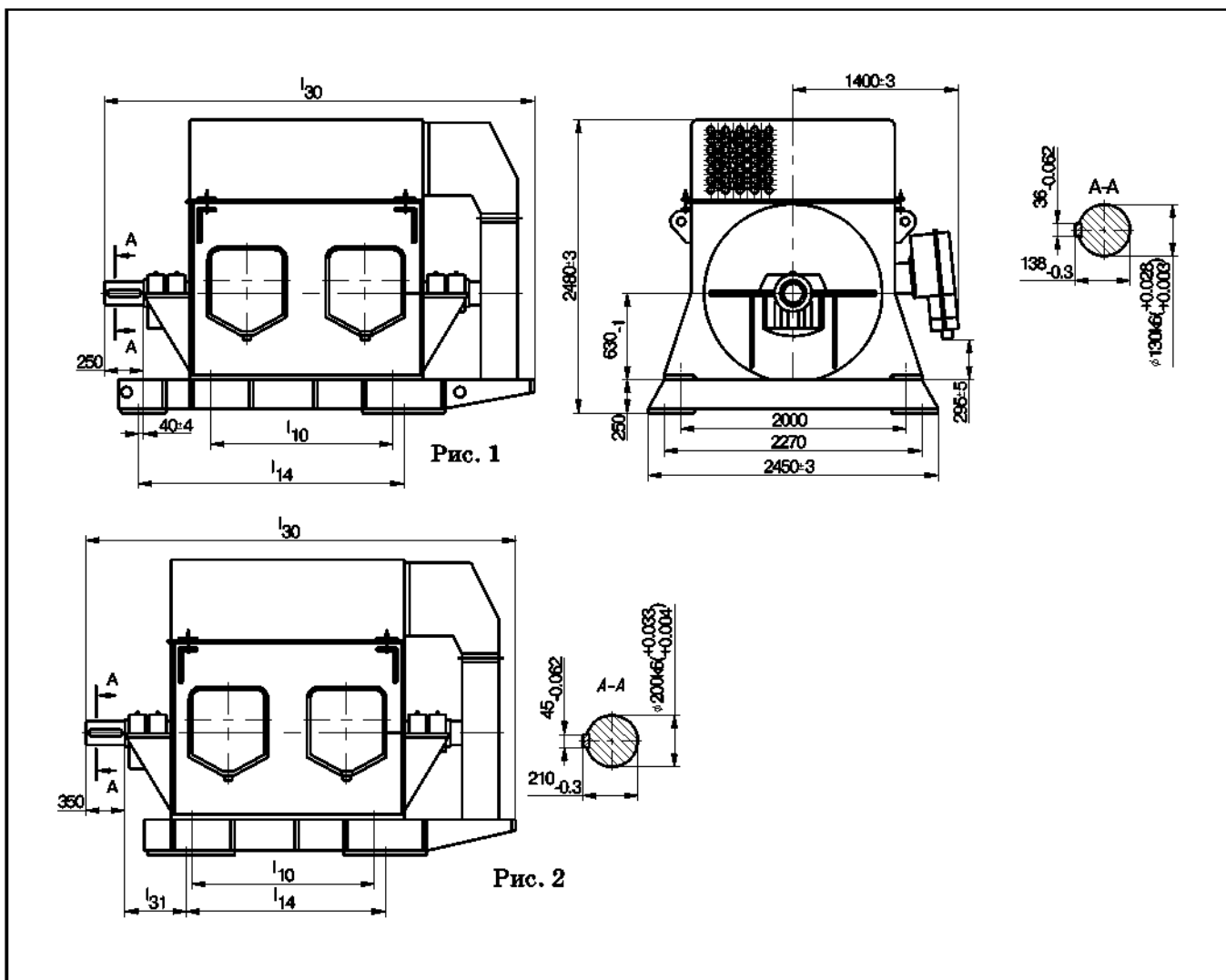

INDUCTION ELECTRIC TWO-SPEED SQUIRREL-CAGE ROTOR MOTORS TYPE 2AOD

Overall, mounting, connecting dimensions and mass of the motors type 2AOD equipped with sliding bearings.

Type	l_{10}	l_{14}	l_{30}	l_{34}	Picture	Placement of terminal box	Mass moment of inertia, kgm ²	Mass, kg	number of figure
2AODS-1600/800-6/8U1	1400	2250±1,5	3540±5	530±4	It is represented	right	1277	13700	2
2AODS-1250/630-6/8U1		2250±1,5	3440±5	480±4			1134	12450	2
2AODS-1000/500-6/8U1	1120	2010±1,5	3145±5	-			847	10600	1
2AODS-800/400-6/8U1	1000	1760±1,5	3015±5	-			775	10190	1
2AODS-630/315-6/8U1		1760±1,5	3015±5	-			632	9510	1
2AODS-1250/630-8/10U1	1400	2250±1,5	3540±5	530±4			1421	13900	2
2AODS-1000/500-8/10U1		2250±1,5	3440±5	480±4			1134	12270	2
2AODS-800/400-8/10U1	1120	2010±1,5	3145±5	-			990	11550	1
2AODS-630/315-8/10U1	1000	1760±1,5	3015±5	-			818	10350	1
2AODS-500/250-8/10U1		1760±1,5	3015±5	-			675	9590	1
2AODS-800/400-10/12U1	1400	2250±1,5	3540±5	530±4			1421	13650	2
2AODS-630/315-10/12U1		2250±1,5	3440±5	480±4			1206	12520	2
2AODS-500/250-10/12U1	1120	2010±1,5	3145±5	-			1062	11860	1
2AODS-400/200-10/12U1	1000	1760±1,5	3015±5	-			847	10330	1
2AODS-1600/800-6/8U1	1400	2250±1,5	3540±5	530±4	Mirror reflection	left	1277	13700	2
2AODS-1250/630-6/8U1		2250±1,5	3440±5	480±4			1134	12450	2
2AODS-1000/500-6/8U1	1120	2010±1,5	3145±5	-			847	10600	1
2AODS-800/400-6/8U1	1000	1760±1,5	3015±5	-			775	10190	1
2AODS-630/315-6/8U1		1760±1,5	3015±5	-			632	9510	1
2AODS-1250/630-8/10U1	1400	2250±1,5	3540±5	530±4			1421	13900	2
2AODS-1000/500-8/10U1		2250±1,5	3440±5	480±4			1134	12270	2
2AODS-800/400-8/10U1	1120	2010±1,5	3145±5	-			990	11550	1
2AODS-630/315-8/10U1	1000	1760±1,5	3015±5	-			818	10350	1
2AODS-500/250-8/10U1		1760±1,5	3015±5	-			675	9590	1
2AODS-800/400-10/12U1	1400	2250±1,5	3540±5	530±4			1421	13650	2
2AODS-630/315-10/12U1		2250±1,5	3440±5	480±4			1206	12520	2
2AODS-500/250-10/12U1	1120	2010±1,5	3145±5	-			1062	11860	1
2AODS-400/200-10/12U1	1000	1760±1,5	3015±5	-			847	10330	1

INDUCTION ELECTRIC TWO-SPEED SQUIRREL-CAGE ROTOR MOTORS TYPE 2AOD

Specifications for electric motors type 2AOD equipped with rolling-contact bearings

Type	Power, kW	U, V	Frequency, Hz	Synchronous speed of rotation, rpm	Stator current, A	Efficiency, %	Power factor	Mmax Mnom	Ms Mnom	Iki Inom	Mass moment of Iner- cla, kgm ²	
											of rotor	of mechanism admissible
2AODK-1000/500-6/8U1	1000/500	6000	50	1000/750	116/62	93.9/93.0	0.88/0.84	2.4/2.3	1.2/1.2	6.5/6.2	847	6.8
2AODK-800/400-6/8U1	800/400	6000	50	1000/750	93/50	93.4/92.5	0.89/0.83	2.2/2.3	1.1/1.3	6.2/6.5	775	6.3
2AODK-630/315-6/8U1	630/315	6000	50	1000/750	74/40	92.8/91.8	0.88/0.82	2.3/2.3	1.1/1.2	6.5/6.0	632	5.3
2AODK-800/400-8/10U1	800/400	6000	50	750/600	97/55	93.7/92.7	0.85/0.75	2.1/2.4	1.2/1.4	5.8/6.0	990	14.5
2AODK-630/315-8/10U1	630/315	6000	50	750/600	78/44	93.4/92.4	0.83/0.75	2.2/2.2	1.2/1.2	6.3/5.8	818	10.9
2AODK-500/250-8/10U1	500/250	6000	50	750/600	63/36	92.9/91.7	0.82/0.72	2.2/2.3	1.2/1.3	6.2/6.2	675	7.6
2AODK-500/250-10/12U1	500/250	6000	50	600/500	66/38	93.5/92.2	0.78/0.69	2.1/2.2	1.2/1.3	5.8/5.8	1062	11.6
2AODK-400/200-10/12U1	400/200	6000	50	600/500	52/32	93.1/91.2	0.79/0.65	2.1/2.3	1.1/1.3	5.6/5.8	847	8.4
2AODK-500/250-6/8U1	500/250	6000	50	1000/750	60/32	92.1/91.0	0.87/0.82	2.3/2.2	1.1/1.1	6.5/6.0	480	4.7
2AODK-400/170-6/8U1	400/170	6000	50	1000/750	48/23.5	93.1/91.8	0.86/0.76	2.5/2.6	1.2/1.2	6.5/6.0	320	3200
2AODK-250/125-8/10U1	250/125	6000	50	750/600	32/18.2	91.9/90.6	0.82/0.73	2.7/2.8	1.1/1.1	6.0/6.0	325	4500
2AODK-315/160-8/10U1	315/160	6000	50	750/600	40/22.8	92.4/91.4	0.82/0.74	2.4/2.6	1.1/1.1	6.0/6.0	365	6400
2AODK-400/200-8/10U1	400/200	6000	50	750/600	51/28.4	92.8/91.7	0.82/0.74	2.4/2.7	1.1/1.1	6.0/6.0	400	7500
2AODK-250/150-10/12U1	250/150	6000	50	600/500	36/26.5	92.0/90.7	0.73/0.60	2.6/2.8	1.2/1.2	6.0/5.5	400	8500

Overall, mounting, connecting dimensions and mass of the motors type 2AOD equipped with rolling-contact bearings

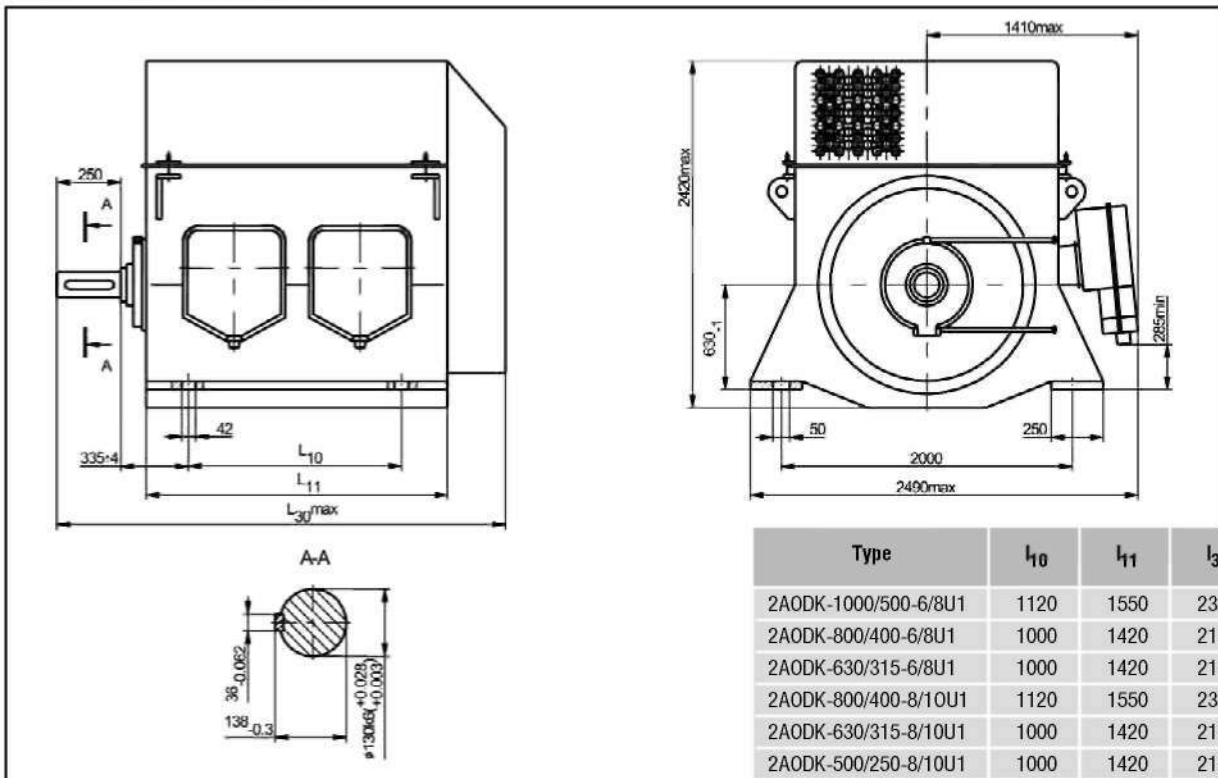

Type	l ₁₀	l ₁₁	l ₃₀	Mass, kg
2AODK-1000/500-6/8U1	1120	1550	2320	8990
2AODK-800/400-6/8U1	1000	1420	2190	8595
2AODK-630/315-6/8U1	1000	1420	2190	8045
2AODK-800/400-8/10U1	1120	1550	2320	9730
2AODK-630/315-8/10U1	1000	1420	2190	8720
2AODK-500/250-8/10U1	1000	1420	2190	8110
2AODK-500/250-10/12U1	1120	1550	2320	9895
2AODK-400/200-10/12U1	1000	1420	2190	8790
2AODK-500/250-6/8U1	1000	1420	2190	7340

INDUCTION ELECTRIC TWO-SPEED SQUIRREL-CAGE ROTOR MOTORS TYPE 2AOD

Overall, mounting, connecting dimensions and mass of the motors type 2AOD equipped with rolling-contact bearings and height of motor with frame size range up to 560 mm

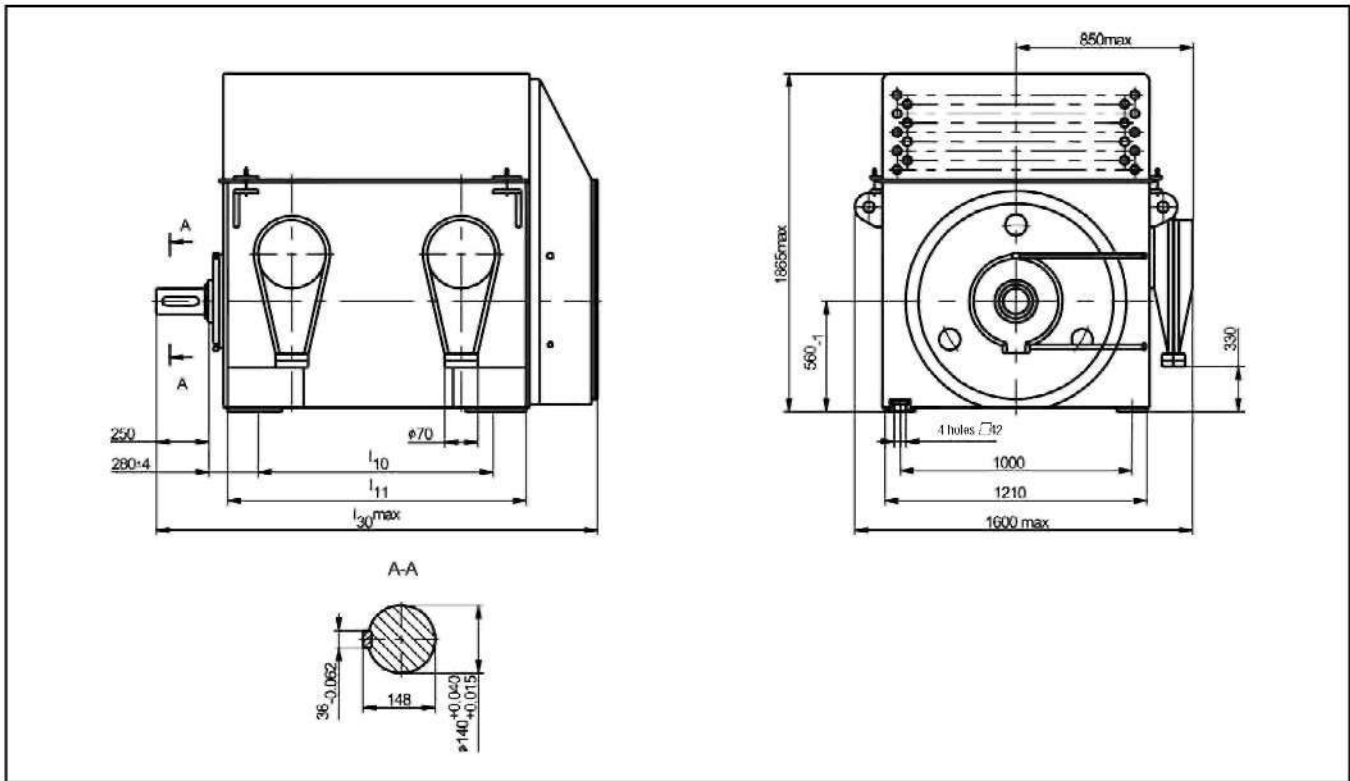

Type	l_{10}	l_{11}	l_{30}	Mass, kg
2AODK-400/170-6/8U1	1120	1490	2270	5150
2AODK-250/125-8/10U1	1120	1490	2270	5050
2AODK-315/160-8/10U1	1120	1490	2270	5145
2AODK-400/200-8/10U1	1250	1640	2420	5460
2AODK-250/150-10/12U1	1120	1550	2330	5270