

## INDUCTION ELECTRIC MOTORS TYPE 4MTH-400



Induction three-phase squirrel-cage rotor motors type 4MTH-400 are designed for driving cranes, hoists and auxiliary mechanisms in the metallurgical industry.

Motors are designed for operation at a voltage of 380 V from the 50 Hz AC mains.

Climatic versions - U1, T2.

The rated duty: 4MTH - S3, 4MTHF - S1

Type of construction - IM1003, IM1004 with one or two free shaft extensions.

Two types of enclosures are available: 4MTH - totally blowed enclosed motors with the degree of protection IP54; 4MTHF - guarded motors with independent ventilation with the degree of protection - IP20.

Motors are suitable for direct-on-line starting with connecting the starting resistor into the rotor circuit.

Maximum to rated torque ratio is 2.8. Motors have grease-lubricated rolling-contact bearings. Motors can be coupled with the driven mechanism with the help of flexible coupling or gearing. Stator and rotor winding silicone insulation is of class "H". Stator and rotor windings are star-connected. Motors allow both clockwise and counterclockwise rotation. The reversal is from a stand-still.

### Specifications for electric motors series 4MTH(F)

Type	Power, kW	Synchronous speed of rotation, rpm	Efficiency, %	cosφ, o.e.	Stator current, A	Rotor current, A	U, V	Rated torque, kNm	Mass moment of inertia, kgm <sup>2</sup>
4MTH(F)-400S8U1, T2	132	750	92,3	0,8	272	272	308	1,7	52,2
4MTH(F)-400M8U1, T2	160	750	93,3	0,79	330	266	379	2,1	60,3
4MTH(F)-400L8U1, T2	200	750	93,5	0,8	407	271	463	2,6	70,4
4MTH(F)-400S10U1, T2	110	600	90,5	0,73	240	251	280	1,75	41,6
4MTH(F)-400M10U1, T2	132	600	91,3	0,73	285	249	336	2,1	51
4MTH(F)-400L10U1, T2	160	600	91,3	0,73	355	242	420	2,55	61
4MTHS400-L10U2-3	200	600	92,6	0,75	436	236	527		

## INDUCTION ELECTRIC MOTORS TYPE 4MTH-400

Overall, mounting, connecting dimensions and mass of the motors type 4MTH

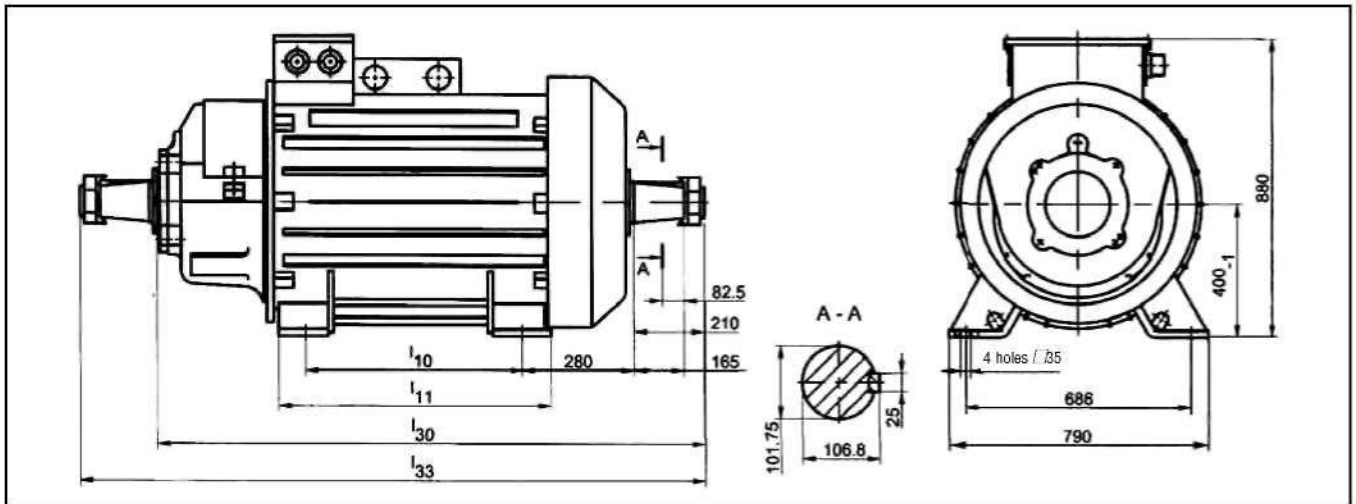

Type	l <sub>10</sub>	l <sub>11</sub>	l <sub>30</sub>	l <sub>33</sub>	Mass, kg	
					one free shaft extensions	two free shaft extensions
4MTH-400S8-1	560	710	1472	1735	1230	1255
4MTH-400M8-1	630	790	1552	1815	1380	1405
4MTH-400L8-1	710	860	1622	1885	1480	1545
4MTH-400S10	560	670	1402	1665	1255	1280
4MTH-400M10	560	710	1473	1736	1420	1445
4MTH-400L10	630	790	1553	1816	1580	1605

Overall, mounting, connecting dimensions and mass of the motors type 4MTHF

Type	l <sub>10</sub>	l <sub>11</sub>	l <sub>30</sub>	l <sub>33</sub>	Mass, kg	
					one free shaft extensions	two free shaft extensions
4MTHF-400S8-2	560	710	1472	1735	1230	1255
4MTHF-400M8-2	630	790	1552	1815	1380	1405
4MTHF-400L8-2	710	860	1622	1885	1480	1545
4MTHF-400S10-2	560	670	1402	1665	1250	1275
4MTHF-400M10-2	560	710	1473	1736	1415	1440
4MTHF-400L10-2	630	790	1553	1816	1575	1600

